

User Guide

The Synchro Drive Clutch

D932



www.guidosimplex.it

Dear Customer,

Thank you for having purchased a Guidosimplex device,

As with all of our products, this device, was designed and created respecting the highest possible levels of quality and safety standards.

All Guidosimplex products are manufactured from the best materials available on today's market , this means that when you buy a Guidosimplex product you buy quality and reliability, which results in less maintenance.

Guidosimplex products coexist in perfect harmony in parallel with the original commands and design of the vehicle and conventional driving can be restored on command.

This device is capable of fulfilling all needs as per design as long as a correct usage is performed.

Therefore we advise you to consult the below reported user guide prior to using the device.



THE SYNCHRO DRIVE CLUTCH

The D932 is the Guidosimplex device which automates the vehicles original mechanical transmission. This device was designed in accordance with regulations and standards and is suitable to all vehicle types with a conventional manual gearbox. The D932 does not impact negatively the performance of the vehicle as it is powered by a dedicated servomotor.

It consists of three main parts:

- ECU**

Which processes the signal received from the cars RPM sensor and transmits the command via the servomotor to the clutch pedal.

- The command console**

The console panel is positioned on the passenger side of the vehicle , it has three buttons providing the driver with three different modules to choose from.

- Gear stick knob.**

Incorporated sensors required to actuate the device.

OPERATING THE DEVICE

The clutch is automatically depressed when the engine is turned on, in order to move the vehicle insert the first gear and accelerate, the clutch engagement is proportional to this action e.g. a slow/fast start depends entirely on the amount of pressure which is applied on the accelerator.

At speeds below 20 km/h the clutch is automatically depressed whenever the accelerator is fully released, above 20km/h whenever you need to change gear simply place your hand over the gear stick sensors **A** to depress the clutch smoothly and automatically, vice versa removing your hand releases the clutch compatible to the actual speed of the vehicle.

During deceleration , caused also by sudden braking, the original braking features of the vehicle remain unaltered as the clutch is depressed at a speed below 25km/h , if acceleration is again requested the reintegration of the clutch is proportional to the amount of pressure applied on the accelerator pedal regardless to the gear inserted.

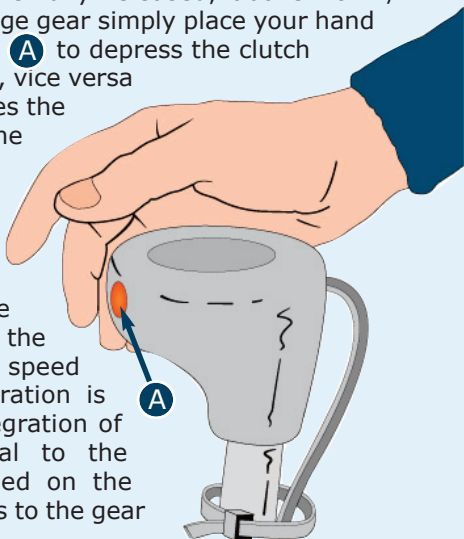

Whenever conventional driving is required e.g. using the original pedals , the Synchro Drive Clutch can be switched off using the red button on the command console fig 1.

OPERATING THE COMMAND CONSOLE

1 Red Button

Switch the device on or off.
When this light is on the device is active



Fig.1

2 Green Button

Engages the engine brake in order to maintain a speed below 20km/h , this facilitates driving down steep slopes where maximum braking power of the engine is necessary but without overheating the brakes. When this light is on this feature is active

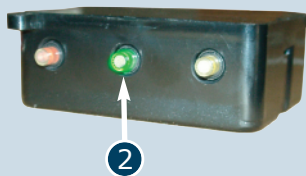

Fig.2

3 Yellow Button

This button activates the "Sport Driving Mode" which becomes available when the vehicle exceeds 40km/h , this feature enables a much faster gear change
When this light is on the device is active

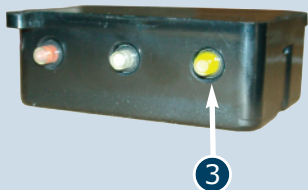

Fig.3

USAGE, MAINTENANCE INSTRUCTIONS AND WARNINGS

USAGE:

Starting the vehicle: Activate the device by pressing the Red button on the command console, make sure that the transmission is in neutral before starting the engine.

Departing: starting the engine automatically depresses the clutch , insert the gear and push down gradually on the accelerator.

Braking: the vehicle will stop below 20km/h regardless of the gear inserted without causing the engine to shutdown.

Switching off the vehicle: turn off the ignition and ensure that the transmission is in neutral.

WARNINGS:

In order to avoid the unnecessary engagement of the clutch whilst driving be careful not to obscure or cover the sensors "A" incorporated into the gear knob.

In the event of any malfunctioning or blockage of the device (green or yellow lights flashing) enter the neutral gear position and press the "B" button , this will reset the device.

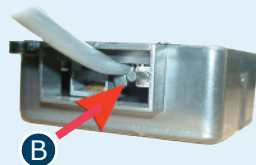
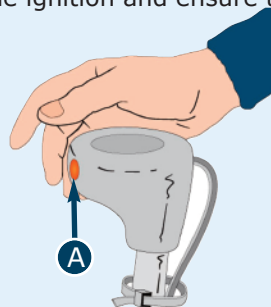

MAINTENANCE:

Maintenance must be carried out at an authorised service center. The first service should be done after 10,000 km and then after every 20,000km. The motor brushes should be controlled every 20,000 km and if necessary replaced.

In the case of malfunctioning or any other problem related to the device in question please contact the nearest authorised Guidosimplex Dealer.

www.guidosimplex.it

This user guide was printed by Guidosimplex S.r.l. and cannot be considered a valid warranty document.

Guidosimplex reserves the right to update without notice the document in question.

Reserved Copyrights. Guidosimplex S.r.l.



Guidosimplex S.r.l.
Via del Podere San Giusto, 29
00166 Roma
Tel. 06 6152801 r.a.
Fax 06 61528036
infoclient@guidosimplex.it
www.guidosimplex.it

CENTRO ASSISTENZA AUTORIZZATO